

# AURA

## CARAVANS



Affordable Luxury  
**TITANIUM SERIES**





1

1) Ultra modern interior design with rolled edge benchtops, recessed cook top and high gloss furniture. 2) Plenty of storage space and strong metal sided drawer runners. 3) Stylish and feature packed bathrooms including washing machine. 4) Composite panel rear with high black checker plate for style with reverse camera for safety. 5) Comfortable microfibre leather upholstery with tri-folding cafe table. 6) Large tunnel boot for storage with two access doors.



2

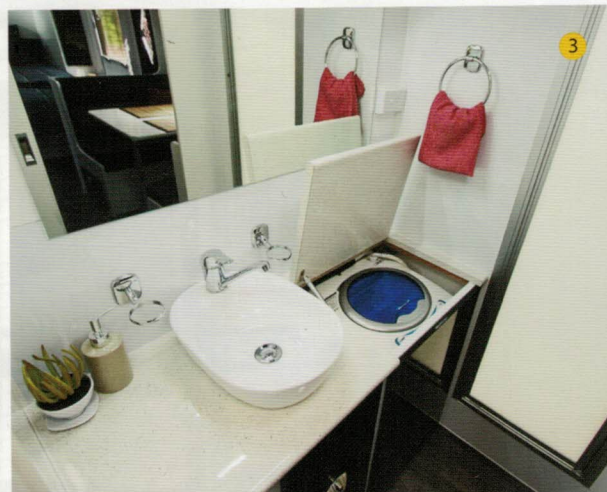

3

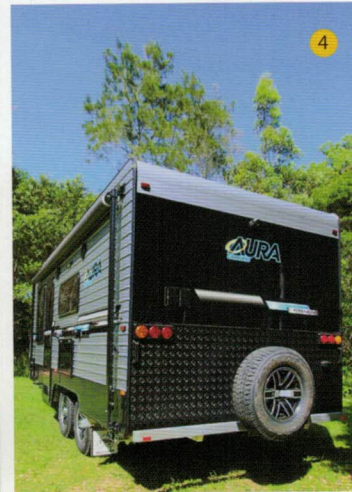

4



6



5



# TITANIUM SERIES FLOORPLANS

Titanium Series Single Axle 17'5"

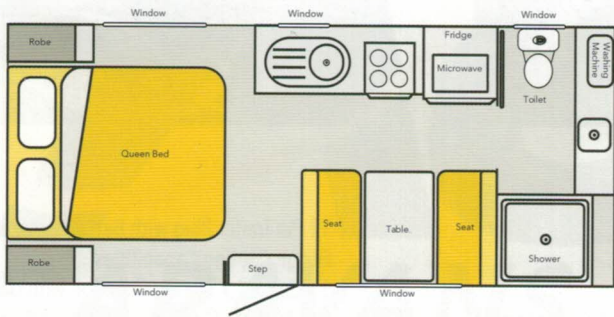

Titanium Series Tandem Axle 21" Bunks

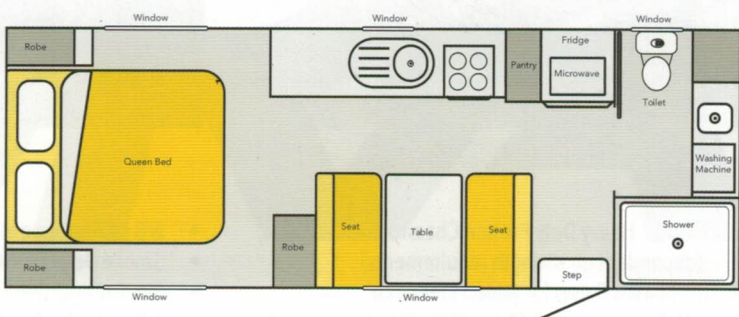

Titanium Series Tandem Axle 18'5"

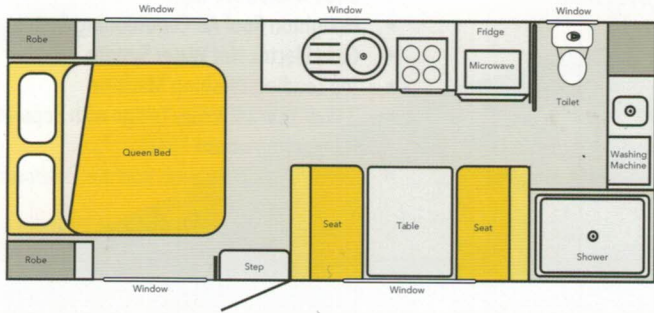

Titanium Series Tandem Axle 21"

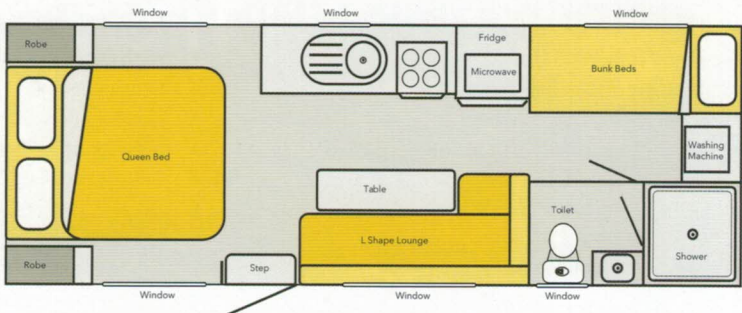

Titanium Series Tandem Axle 19'5"

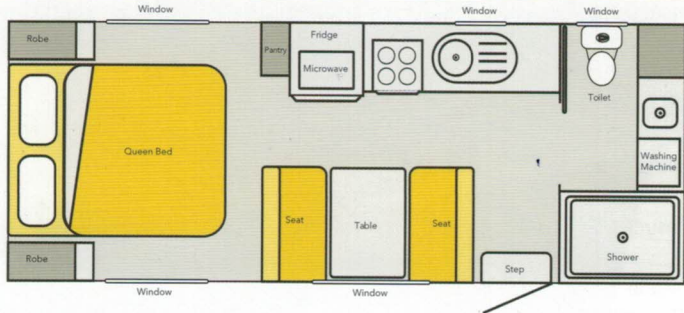

Titanium Series Custom Build

The Titanium Series has been designed from the chassis to the roof to offer what we believe to be the best value caravan in todays competitive market.

To ensure Aura Caravans continue to provide you with the best possible price in the Titanium, custom building is not an available option however we may possibly be able to make minor modifications to suit your needs where we can. Talk to your local dealer to find out more.

Single Beds

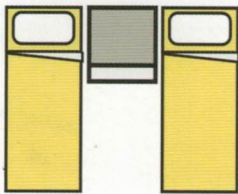

Queen Bed

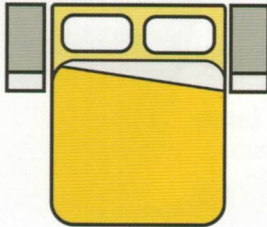

Cafe Lounge

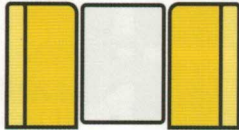

L Shape Lounge

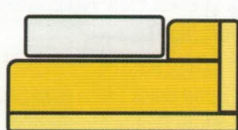

Single & Tandem Axle Available



# TITANIUM SERIES SPECIFICATIONS



## Chassis

- 4" or 6" Heavy Duty Preston Chassis (dependent on strength requirements)
- 2" Chassis Raiser for Added Clearance (4" chassis models only)
- Stylish 15" Alloy Wheels
- 8" Solid Rubber Jockey Wheel
- Large Jockey Wheel Clamp
- Heavy Duty Wind Up Jack
- Lockable 50mm Ball Coupling
- 2 Arm Heavy Duty Bumper Bar
- Alloy Spare Wheel Fitted to Bumper Bar
- Twin Safety Chains
- 10" Electric Brakes to All Wheels (12" brakes on 17'6 model)
- Straight Axles for Extra Clearance
- A-Frame Tap with Stone Protection
- Easy Lift Up/Drop Down Stabiliser Legs
- Galvanized Wheel Arches
- Galvanized Water Tank Stone Guard Protection
- Leaf Spring Suspension

## Exterior

- Stylish Digital Print Decals
- Insulated Roof and Walls with Meranti Timber Frame
- Quality Roll Out Awning
- Double Glazed Push Out Windows & Integrated Blinds
- Galvanized Front Tunnel Boot with Large Access Doors
- Black Checker Plate Front, Sides and Rear (1 sheet high)
- Black External Trims
- Luca Bond Black Gloss Rear Panel
- Silver High Profile Aluminium Cladding
- Triple Locking Security Main Door
- 2x Mini Roof Skylights with Blind & Flyscreen (1 skylight on 17'6 + 18'6 model)
- Grab Handles to each Corner of Van
- External Fold Down Picnic Table
- Generator Compartment Hatch (where layout allows)
- Checker Plate Door Entry Step & Surround
- One Piece Fibreglass Roof (less joins for a better finish)

Authorised Dealer

## Interior

- 6'8 Ceiling Height
- Smoke Detector Fitted
- Fire Extinguisher Fitted
- Lift up Under Bed Storage (not available on single beds)
- Recessed Cook Top with Lid Over Stove (more bench space)
- High Quality Stylish Rolled Edge Post Form Benchtops
- Plastic Cutlery Drawer Insert
- Innerspring Mattress to Queen or Single Beds
- Large Stylish Grab Handle on Entry Wall at Door
- Drawers on Metal Runners
- Stylish Positive Locking Door Latches with Gas Struts
- Quality Hinges on all Cupboard Doors
- Very Large Range of Interior Colours to Choose From
- Gloss or Matte Solid Cupboard Doors Throughout
- Full Gloss or Matte Laminate Splashback and Benchtops
- Plush Microfibre Leatherette Upholstery with Side Swabs to Dinette
- Tri-Fold Cafe Table or L-Shape Lounge (no TIC cushion incl.)
- Separate Shower & Toilet Ensuite with Glass Door Shower
- Full Height Cupboard in Ensuite
- Single Towel Rails & Toilet Roll Holder
- Bed Head Padding

## Electrical / Appliances

- LED External Clearance, Side and Tail Lights
- 1 x LED External Annexe Light
- LED Lighting to Roof, Kitchen, Ensuite
- 2 LED Reading Lights in Bedroom
- 2 LED Reading Lights in Lounge
- Battery Pack with Smart Charger & 100Amp Battery Fitted on Chassis
- Roof Top Digital TV Antenna
- 21" Flat Screen TV on Wall Mounted Bracket
- DVD/CD/Radio Player with 2 x Internal Roof Speakers
- 2 x External Marine Speakers

- 12 Pin Trailer Plug with Battery Charging & Fridge Cooling Capabilities
- 3 x Gas & 1 x Electric Cook Too with Gas Griller and Full Gas Oven
- 12V Range Hood
- 240V Microwave Oven
- Houghton Roof Air Conditioning System
- Gas / Electric Hot Water System
- Top Loading Washing Machine
- 3 Way 12V/240V/Gas Fridge with Separate Freezer (minimum 184L)
- Fridge Vented Through Roof for Optimum Performance
- 240V Power Points (2x Bedroom, 1x Kitchen, 1x Lounge, 1x Ensuite)
- 240V 15 Amp Inlet & 240V 15Amp Outlet
- Circuit Breaker & Earth Leakage
- 1 x 150W Solar Panel & 30Amp Regulator
- Reversing Camera & Car Monitor Kit
- 12V/USB Socket at Kitchen Table & External Table
- TV Coaxial Point at External Table
- Entry Light and Grab Handle
- 12V Fan Hatch to Shower & Toilet

## Plumbing

- Mains Pressure Water Inlet
- Waste Water Outlet
- Lockable Water Filler Inlet
- 2 x 80L Water Tanks
- 12V Water Pump
- 2 x 9Kg Gas Bottles with Changeover Regulator
- A-Frame Mains Pressure Tap
- External Gas Bayonet near Front Tunnel Boot
- Water Tank Gauge
- China Vanity to Ensuite
- Ceramic Bowl Toilet
- Flick Mixer Taps - Kitchen and Ensuite
- Large Deep Bowl Stainless Kitchen Sink with Drainer
- Filtered Water Tap at Kitchen Sink

## SERIES 2 UPGRADE PACKAGE

- Mesh A Frame
- China Toilet Bowl
- External TV Box
- Metal Grab Handles
- Black Cover Gas Regulator
- Front and Back Composite
- Plastic Wheels' Pats N/A with Off Road Tyres
- Volt Meter
- Dual 95L Water Tanks
- Shelves in OHC

## EXPLORER SERIES PACK

- Al-KO Endura Outback
- 16 Inch Wheels
- DO-35 Coupling
- 6-Inch Chassis
- Extra Battery
- Grey Water Tank
- Extended A Frame
- Extra Solar Panel

*"It's your time"*

auracaravans.com.au

All information contained in this brochure was correct at the time of printing and is subject to change without notice. Photographs are strictly for illustration purposes only and may show some non standard features.

**AURA**  
CARAVANS