

Windsor

otway

built by **apollo**



VEHICLE

Fiat Ducato LWB MR
9 speed full automatic gearbox
2.3 litre Multijet 3 Power, 4 cylinder
Max Power: 160hp/119kW @ 3500rpm
Max Torque: 400Nm @ 1500rpm
Fuel Tank: 90L diesel + 19L AdBlue
5 yr / 200,000km Fiat Australia Warranty
24/7 Roadside Assistance

APPLIANCES

Air conditioner, Ibis 4 reverse cycle roof top
Cooker with 2x gas burner & glass cover
Fridge/freezer 109L compressor (12V / 240V)
Water Heater 14L (Gas / 240V)
Microwave 25L

POWER & ELECTRICS

Battery 1x 100Ah deep cycle, fully sealed
BMPRO Battery management system
Solar, 190W panel & regulator
Lighting, LED style throughout
Stereo, AM/FM plus CD/MP3/Bluetooth
Power inlet & outlet 240V
Power outlet 12volt & USB charge outlets
Light under awning

EXTERNAL FEATURES

Awning, 3.2m windout cassette style
Antenna, omnidirectional for HDTV reception
Gas cylinder, 1x 4.5kg
Windows, double glazed acrylic with blinds & flyscreens
Roof hatch to living area with day/night blind
Entry step to side door

KITCHEN & PLUMBING

Fresh water, 110 litre storage
Grey water, 55 litre storage
Water level monitor
Kitchen sink, stainless steel with flickmixer
Water filter with replaceable cartridge
Laminated plywood benchtops
Quality kitchen cabinets and fittings

LIVING AREA

Forward facing dinette with adjustable table
2x Swivel front cab seats
2x ADR approved additional seatbelts to dinette
Child restraint anchor points x2, ADR approved

BEDROOM

Rear east-west bed/garage conversion
Overheads storage cupboards both ends of bed
Television, 22 inch (56cm) 12V HD LED DVD/TV

ENSUITE

Fully enclosed shower with frosted glass door
Separate hot & cold tapware
Swivel cassette toilet 18L with electric flush



windsormotorhomes.com.au

*Note: Please be advised all models and specifications are subject to change without notice.

Rev# 170822

Windsor

otway SPECIFICATIONS



DAY LAYOUT

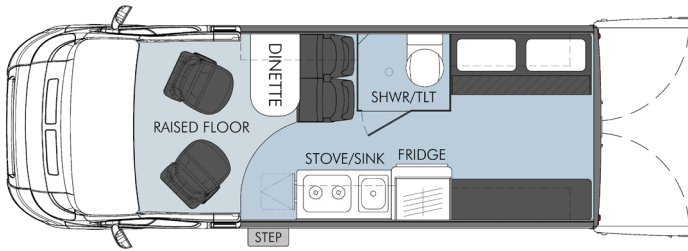

NIGHT LAYOUT

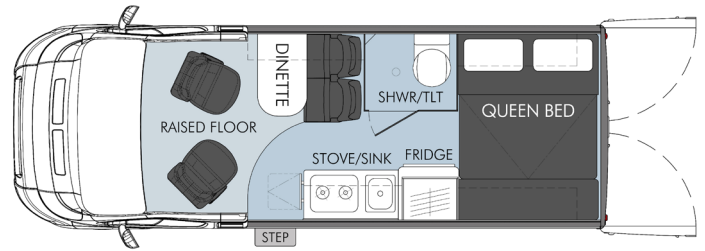

EXTERNAL DIMENSIONS

OA Length (mm)	5998 (19'8")
OA Width (mm) excl mirrors	2050 (6'9")
OA Height (mm)	2770 (9'1")
GVM Weight (kg)	4,250
Kerb Weight (kg)	3,105
Payload (kg)	659

INTERNAL DIMENSIONS

Floor Plan Length (mm)	4400 (14'5")
Floor Plan Width (mm)	1870 (6'2")
Ceiling Height (mm)	1905 (6'3")
Bed (cm) fold-up	193x140



*Weights & measurements are indicative only

OPTIONAL EXTRAS

- Battery, additional 100Ah deep cycle battery
- Battery, 1x 100Ah Lithium battery
- BBQ gas bayonet fitting
- Diesel heater, Webasto 2kW single outlet (12V)
- Entry step (12V electric)
- Flyscreen to rear opening barn doors
- Flyscreen to side sliding door
- Inverter, Projecta Pure Sine Wave 1000W

*Note: Appliances may vary depending on availability. Not all items may be listed in this publication. Specifications are subject to change due to continuous product improvement.