

ACTIVE  
CARAVANS

# STORM

2022 CARAVAN RANGE







**BUILT TO THRIVE IN THE TOUGH AUSTRALIAN ENVIRONMENT,  
THE ACTIVE STORM IS RAISING THE STANDARD FOR OFF ROAD CARAVANS.**

**CONSTRUCTED TO GIVE YOU CONFIDENCE TO EXPLORE,  
WHATEVER THE WEATHER.**

---





# STORM

18'6



## INTERIOR FEATURES



# STORM

19'6"



## INTERIOR FEATURES

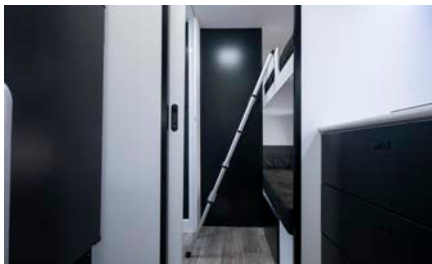





**STORM**  
COUPLES - 19'6



## INTERIOR FEATURES

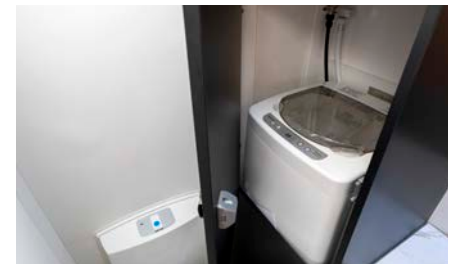

# STORM

## 22'6"



### INTERIOR FEATURES









# FEATURED FLOORPLANS

OTHER LAYOUTS ALSO AVAILABLE



**18' - SINGLE AXEL**

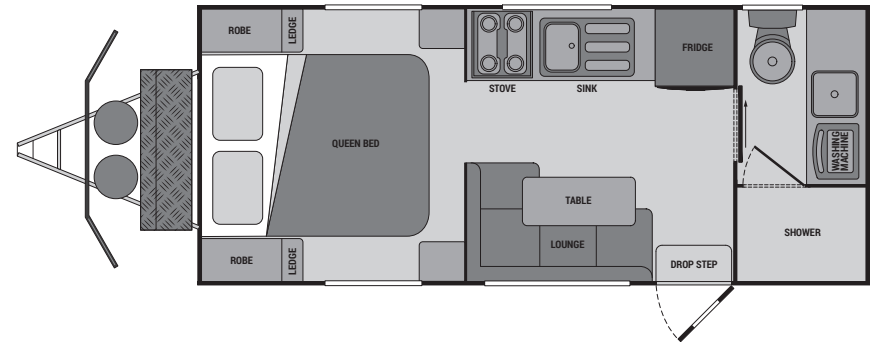

**18'6" - TANDEM AXEL**

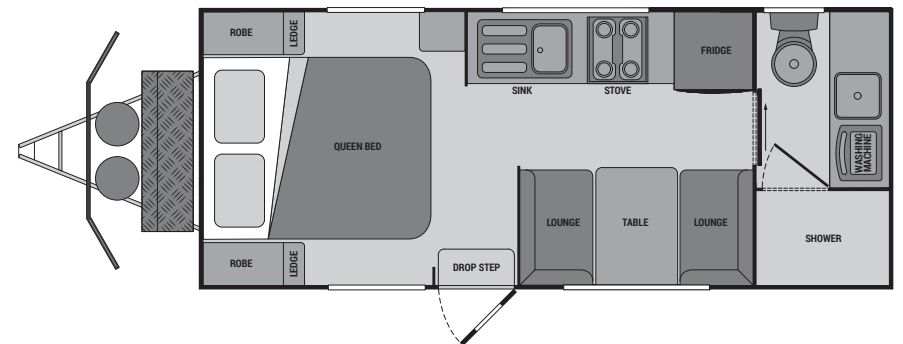



**19'6" - EW FAMILY**

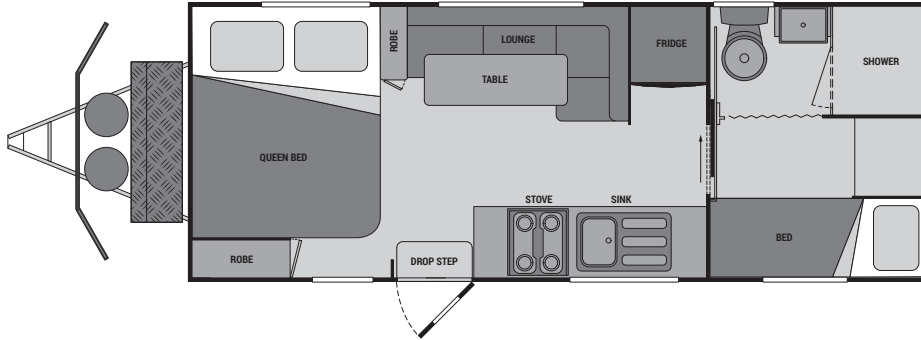

**22' - CLUB**



**19'6" - COUPLES**



**22' - FAMILY**

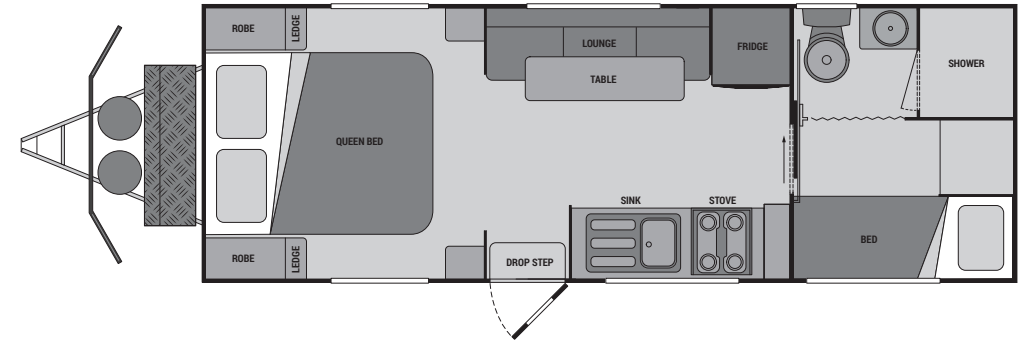

**21' - FAMILY**

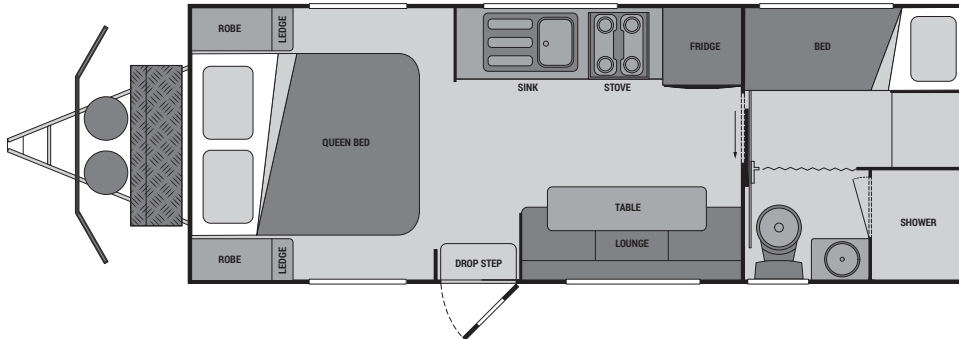

**22'6" - REAR CLUB**

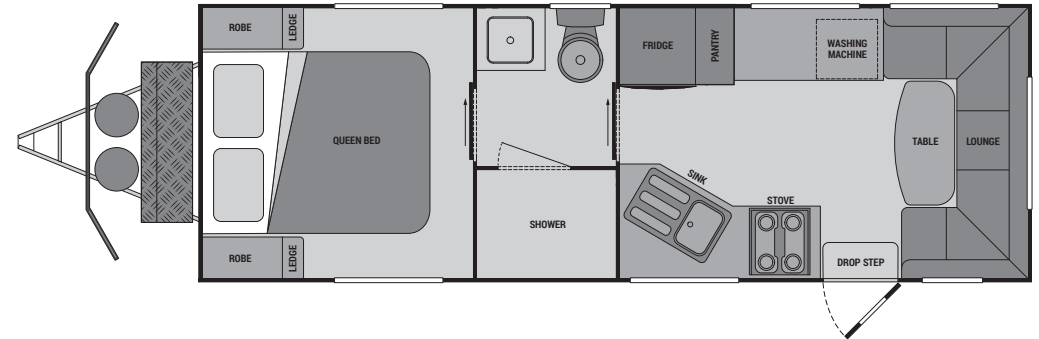



# KEY FEATURES



## INTERIOR

- ALL TERRAIN INTERLOCKING FURNITURE
- POST FORM BENCH TOP
- ALL PLY FURNITURE
- ROLLER BEARING DRAWS
- SOFT CLOSE CATCHES
- RECESSED STOVE TOP
- FAN FORCED OVEN
- DOUBLE GPO'S IN KITCHEN
- FILTERED WATER TO SINK
- LARGE KITCHEN DRAWS
- 2 X ROOF HATCHES
- 2 X ENSUITE HATCHES
- ENSUITE WINDOW
- COMPRESSOR FRIDGE 274LTR
- 6'2 LUXURY ISLAND BED
- OPTIONAL SINGLE BEDS
- 2 X INTERNAL FANS
- EXTERNAL FUSION SOUND BAR
- SATELLITE INPUT POINT
- ONE PIECE SHOWER
- MODERN TAPWARE AND FIXTURES
- BED SWITCH TO ENSUITE LIGHT
- AWNING TRACK TO KERB SIDE
- RV WIFI
- ALL READING LAMPS WITH USB POINTS
- REVERSE CYCLE AIR CONDITIONER
- DIGITAL TV ANTENNA
- ODYSSEY BM PRO BATTERY MANAGER
- 35 AMP SYSTEM WITH TYRE PRESSURE AND GAS TANKS LEVEL DISPLAY
- FUSION BLUETOOTH STEREO
- EXTERNAL FUSION SOUND BAR
- SATELLITE INPUT POINT

## EXTERIOR

- EXTERNAL ENTERTAINMENT AREA
- HATCH 12 VOLTS, USB 240 VOLT
- TV ARM AND POINT
- EXTERNAL INSECT LAMPS
- HOOK UP LIGHT
- 1 X OFF SIDE LIGHT
- 2 X TUNNEL BOOT LIGHTS
- 3 X AWNING LIGHTS
- 3 X 170 WATT SOLAR PANELS
- 300 AMPS OF LITHIUM BATTERY POWER
- SUPER GAL, AUSSIE MADE CHASSIS
- CRUISE MASTER X T COIL SUSPENSION
- WITH TWIN SHOCK OBSORBERS
- CHASSIS RAISER WERE APPLICABLE
- EXTENDED A FRAME
- DO- 35 OFF ROAD COUPLING
- STONE GUARD
- LARGE 2 DOOR TOOL BOX
- WITH GENERATOR SLIDE
- GALVANISED TUNNEL BOOT
- 16" ALL TERRAIN WHEELS AND TYRES
- 4 X 12" BRAKES
- 1 PIECE COATED FLOOR
- UNDER BODY PIPE PROTECTION
- 2 X 95 LTR FRESH TANKS
- 1 X 95 LTR GREY TANK
- EXTERNAL SHOWER
- 3 ARM STRAIGHT BUMBER BAR
- AND SO MUCH MORE..















**ACTIVE**  
CARAVANS

# STORM

FOR MORE INFO, CALL **07 3888 2755**  
OR VISIT **KRATZMANN.COM.AU**

